



## **ASYMMETRICAL POLYAMIDE HINGES WITH CARBON FIBER**

**54-1-3559**

Hinges are made of 30% carbon fiber 6.6 PA.  
Pin: 303 stainless steel.

<b>A</b>	100 mm
<b>Material</b>	polyamide

<b>Weight (g)</b>	115 g
<b>B</b>	150 mm
<b>C</b>	7.8 mm
<b>E (knuckle or thickness)</b>	8.25 mm
<b>D (pin diameter)</b>	7
<b>F (pitch)</b>	48 mm
<b>G (pitch)</b>	75 mm
<b>H (height or starting holes)</b>	62 mm
<b>Finish</b>	black
<b>J</b>	15 mm
<b>Nouvelle référence</b>	NEW

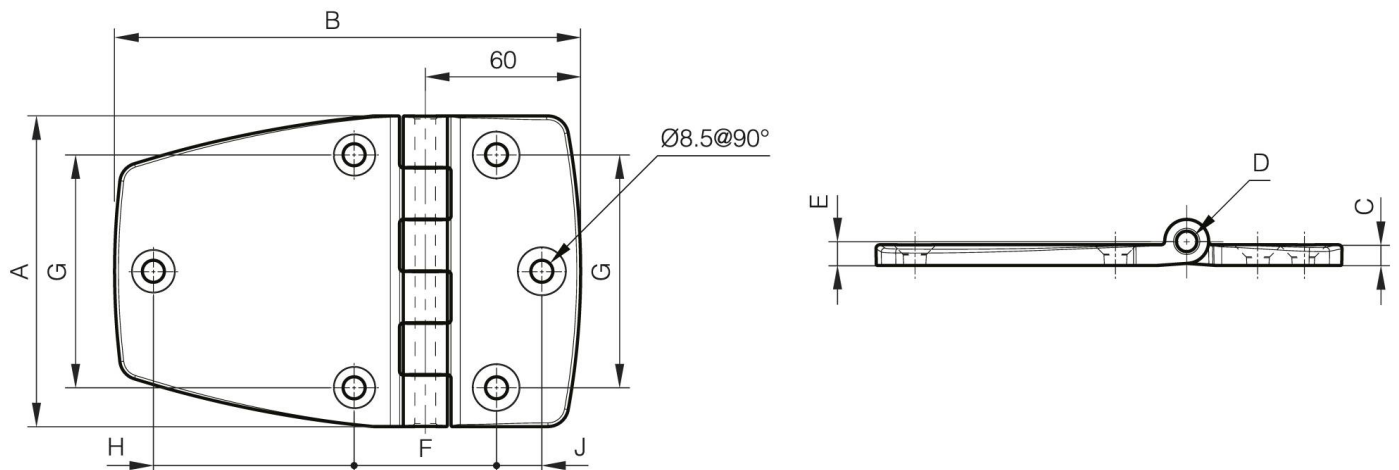

<b>K</b>	50 mm
----------	-------