



ASYMMETRICAL POLYAMIDE HINGES WITH CARBON FIBER

54-1-3556

Hinges are made of 30% carbon fiber 6.6 PA.
Pin: 303 stainless steel.

A	80 mm
Material	polyamide

Weight (g)	100 g
B	120 mm
C	7.8 mm
E (knuckle or thickness)	8.25 mm
D (pin diameter)	7
F (pitch)	50 mm
G (pitch)	55 mm
H (height or starting holes)	40 mm
Finish	black
Nouvelle référence	NS

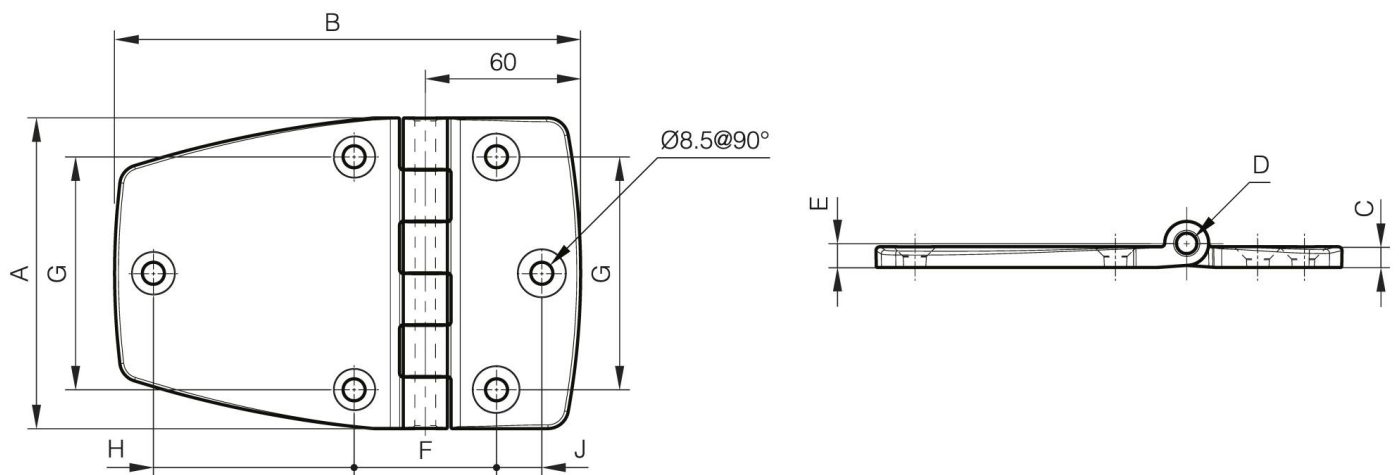

K	40 mm
----------	-------