



POLYMER HINGES WITH OR WITHOUT ADJUSTABLE SPRING TORQUE

54-1-3553

Hinge with adjustable spring torque.

Opening spring force on delivery:

$M(0^\circ)$: 0.75 N.m / $M(90^\circ)$: 0.5 N.m / $M(180^\circ)$: 0.25 N.m

Recommended maximum torque for opening spring: 1.1 N.m at 60° (4 clicks).

Closing spring force on delivery:

$M(0^\circ)$: 0 N.m / $M(90^\circ)$: 0.25 N.m / $M(180^\circ)$: 0.5 N.m

Recommended maximum torque for closing <https://www.pinet-industrie.com/mode-operatoire-charniere-polymere-couple-reglable-version-fermante.pdf>: 1.1 N.m at 120° (6 clicks).

Material: 30% GF reinforced PA 6.

Spring in Bezinal steel.

Other components in POM.

Spring force adjusted with a T27 Torx key in <https://www.pinet-industrie.com/mode-operatoire-charniere-polymere-couple-reglable-version-fermante.pdf> (part number 99-1-3729).

Adjustment instructions:

opening spring [click here](#)

closing spring [click here](#)

A (length)	75 mm
Note	closing spring
Material	polymer
Weight (g)	45 g
B (width)	65 mm
C	5 mm
D (pin diameter)	13
Finish	black
Nouvelle référence	NEW

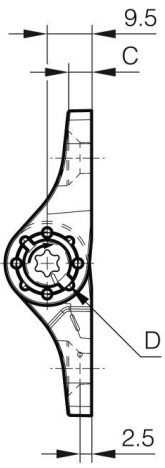

54-1-3552



54-1-3553



54-1-3554

