



SQUARE HINGES WITH NO OFFSET LEAF AND RIVETED PIN - WITH 6 HOLES

52-1-4112

Riveted pin.

A	80 mm
Note	with M5 studs

Material	304 stainless steel
Weight (g)	184 g
B	80 mm
C	2.5 mm
S (hole diameter)	4.5 mm
D (pin diameter)	6
F (pitch)	8 mm
G (pitch)	60 mm
H (height or starting holes)	12.5 mm
Finish	raw
Nouvelle référence	NS

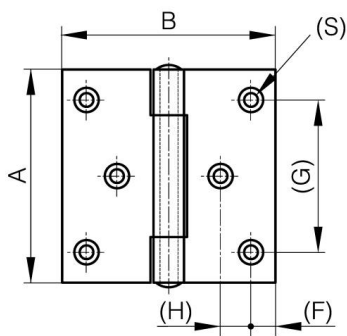

52-1-3867 & 52-1-3868

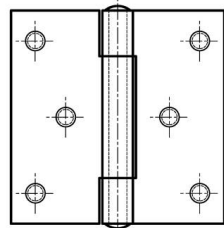

52-1-4109 & 52-1-4112

