



**SQUARE HINGES WITH TWO OFFSET  
LEAVES AND REMOVABLE PIN - WITH 6  
HOLES**

**52-1-4110**

Removable pin.

A	80 mm
---	-------

<b>Note</b>	with M5 studs
<b>Material</b>	304 stainless steel
<b>Weight (g)</b>	182 g
<b>B</b>	80 mm
<b>C</b>	2.5 mm
<b>S (hole diameter)</b>	4.5 mm
<b>D (pin diameter)</b>	6
<b>F (pitch)</b>	8 mm
<b>G (pitch)</b>	60 mm
<b>H (height or starting holes)</b>	12.5 mm
<b>Finish</b>	raw
<b>Nouvelle référence</b>	NS

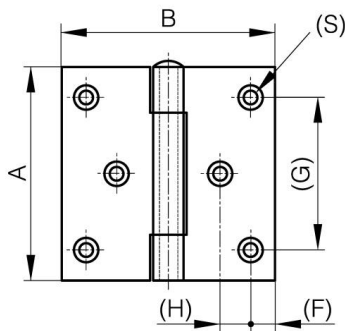

52-1-3614 & 52-1-3616

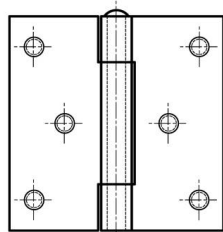

52-1-4107 & 52-1-4110

