



STAINLESS STEEL DUAL BALL CATCHES

16-7-4305

Catch force is not adjustable. Do not turn the slot part.

| | |
|-------------------|---------------------|
| A | 43 mm |
| Material | 316 stainless steel |
| Weight (g) | 18 g |

| | |
|-------------------------------------|----------|
| B | 8 mm |
| C | 13.5 mm |
| S (hole diameter) | 3.2 mm |
| E (knuckle or thickness) | 2.5 mm |
| D (pin diameter) | 28.4 |
| F (pitch) | 35 mm |
| G (pitch) | 16 mm |
| H (height or starting holes) | 25 mm |
| Finish | polished |
| J | 7.5 mm |
| L | 2.5 mm |
| C1 | 10 mm |
| C2 | 6 mm |

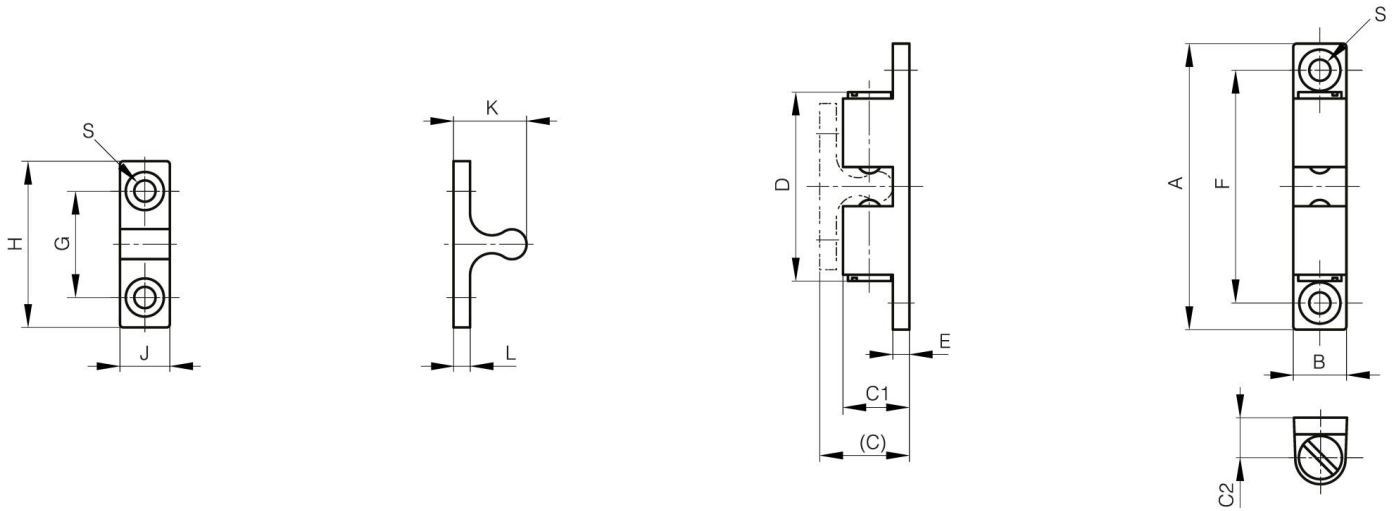

| | |
|----------|-------|
| K | 11 mm |
|----------|-------|