



DUAL BALL CATCHES B

16-7-3423

Strike can be secured on 2 sides of the catch.

Body of the catch: zinc die-cast with brass finish.

Balls: in steel

Strike: in steel with brass finish.

A	41.7 mm
Material	zinc die-cast

Weight (g)	14 g
B	8.5 mm
C	10.7 mm
E (knuckle or thickness)	2.6 mm
D (pin diameter)	26
F (pitch)	34 mm
G (pitch)	16.9 mm
H (height or starting holes)	25.7 mm
Finish	brass
J	8 mm
L	1.2 mm

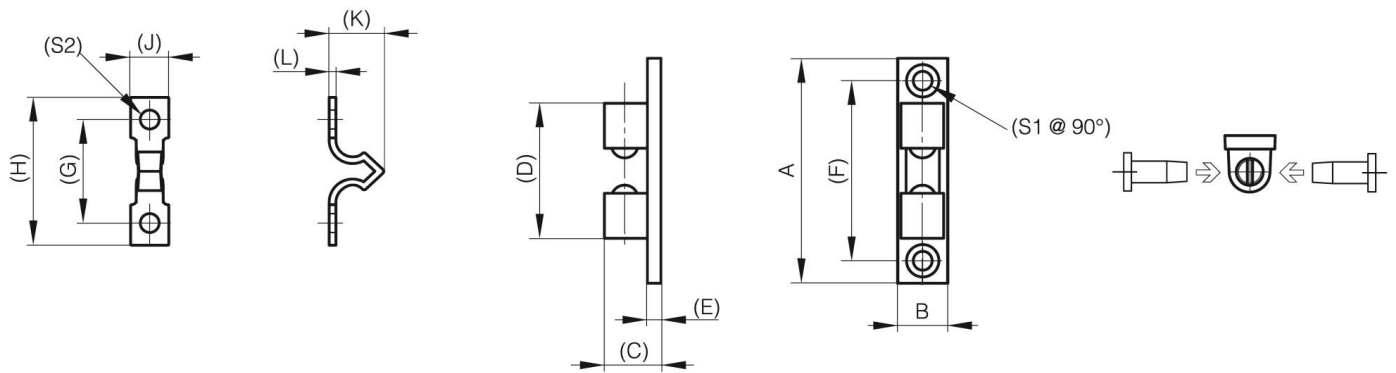

K	13.5 mm
----------	---------