



ZINC DIE-CAST LIFT-OFF HINGES 80 MM

14-7-3813

Fixing by 2 threaded studs. Stainless steel pin.
Leaves blocked with grub screw. Unscrew it to get a lift-off hinge.

A	80 mm
Note	type 2
Material	zinc die-cast

Weight (g)	330 g
B	65 mm
C	8 mm
D (pin diameter)	8
G (pitch)	60 mm
Finish	black

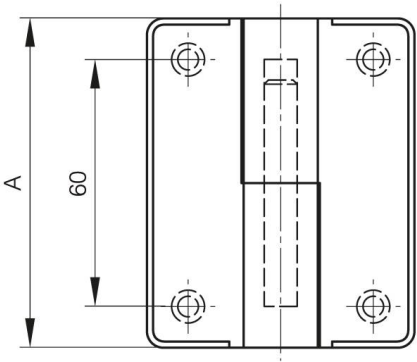

14-7-3814

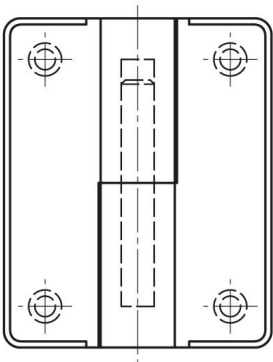

14-7-3813

