



SNAP-IN MAGNETS WITHOUT COUNTERPLATE

16-7-4209

Snap-in magnets for sheet metal applications. Suitable for material thicknesses 1.6 mm or 2.6 mm.
E denotes material thickness.
Cut-out varies to suit metal thickness.
Flex-tab for easy removal.

A (length)	41 mm
------------	-------

Material	POM
Weight (g)	6 g
B (width)	13 mm
C	14.6 mm

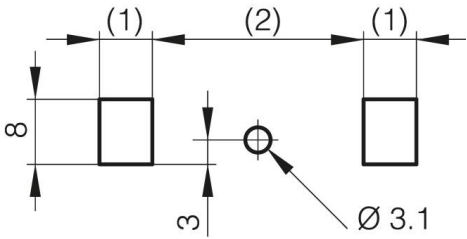
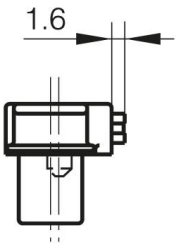
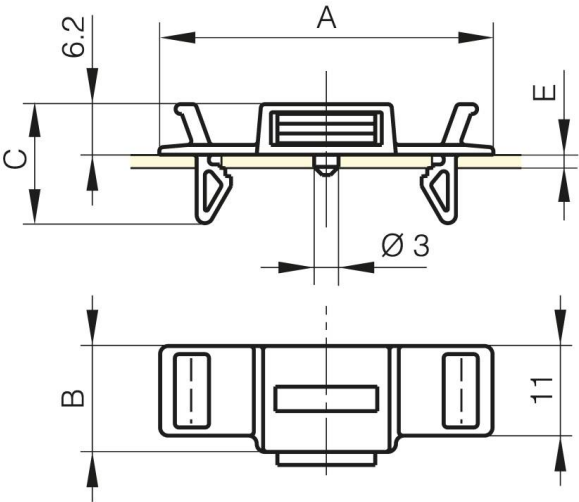

E	(1)	(2)
1.6	6.5	26.0
2.6	5.8	24.6