



FLAG HINGE WITH WASHER - 62 X 62 MM

12-1-3635

Flag hinge with brass washer.

A	62 mm
Note	type 1
Material	steel

Weight (g)	87 g
B	62 mm
C	2.5 mm
E (knuckle or thickness)	30 mm
D (pin diameter)	7
Finish	raw

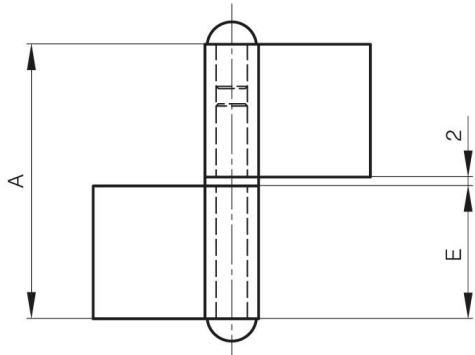

12-1-3635

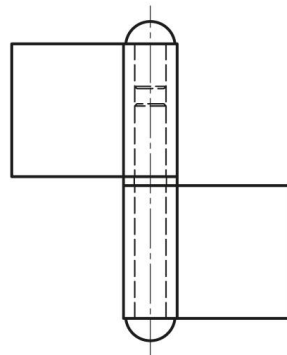

12-1-3634

