



**FLAG HINGE WITH WASHER - FLAT  
KNUCKLE**

**12-1-3314**

Flag hinge with brass washer, included separately.

|                   |         |
|-------------------|---------|
| <b>A (length)</b> | 81.5 mm |
| <b>Note</b>       | type 1  |

|                  |       |
|------------------|-------|
| Material         | steel |
| Weight (g)       | 77 g  |
| B (width)        | 48 mm |
| C                | 2 mm  |
| E                | 40 mm |
| D (pin diameter) | 5.0   |

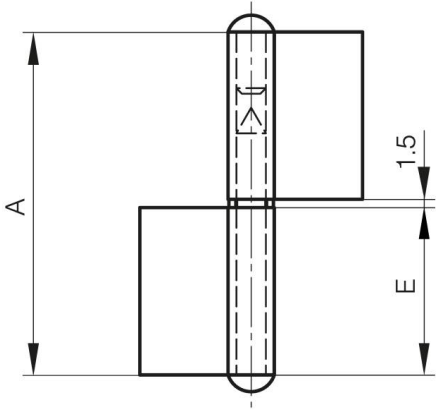

12-1-3312 & 12-1-3314

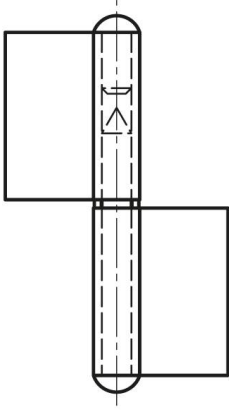

12-1-3311 & 12-1-3313

